



X-DFC DATA SHEET

Double fire clip



X-DFC Double fire clip

Product data

Dimensions

X-DFC 8 MX / X-DFC-W 8 MX

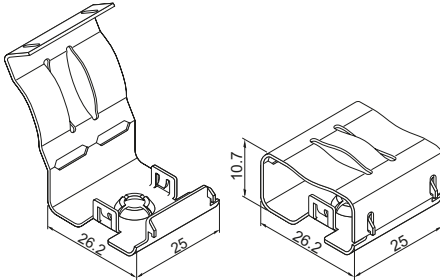

X-DFC 9 MX / X-DFC-W 9 MX

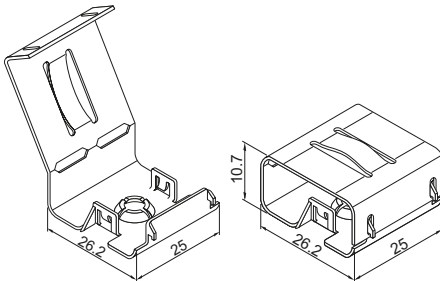

Features and benefits

- Easy and convenient installation to concrete (soft and some tough) and sandlime stone base material
- Quick, cost-efficient fastening
- Can be clicked on BX fastener guide, no adaptor needed
- Tested by an external, certified test institute

General information

Material specifications

X-DFC-MX: Stainless steel with 50 µm red or white colour coating

Approval and standards

Product qualification according to BS EN 50200, BS EN 50200 Annex E and BS 8434-2

In compliance with cable support requirements of BS 5839-1, BS 5839-8 and BS 5266-1

Applications

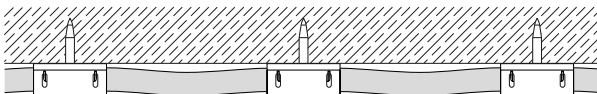

Installation of fire alarm and emergency lighting cables.

Performance data

Fire rating

Cable	Fastener	Cable size	Classification	Test standard
Prysmian FP200 Gold (standard)	X-DFC 8 MX / X-DFC-W 8 MX	2 core x 1.5 mm ² 3 core x 1.5 mm ²	PH 60	BS EN 50200 (dry)
			PH 30	BS EN 50200 Annex E (wet)
Prysmian FP plus (enhanced)	X-DFC 9 MX / X-DFC-W 9 MX	2 core x 1.5 mm ²	PH 120	BS EN 50200 (dry) BS 8434-2 (wet)
Ventcroft NoBurn Platinum (standard)	X-DFC 8 MX / X-DFC-W 8 MX	2 core x 1.5 mm ² 4 core x 1.0 mm ²	PH 60	BS EN 50200 (dry)
			PH 30	BS EN 50200 Annex E (wet)
	X-DFC 9 MX / X-DFC-W 9 MX	2 core x 2.5 mm ² 4 core x 1.5 mm ²	PH 60	BS EN 50200 (dry)
			PH 30	BS EN 50200 Annex E (wet)
Ventcroft NoBurn plus (enhanced)	X-DFC 8 MX / X-DFC-W 8 MX	2 core x 1.5 mm ²	PH 120	BS EN 50200 (dry) BS 8434-2 (wet)

Conditions:

- Pre-loading of the elements after setting
- All visible failures must be replaced.
- Observance of all application limitations and recommendations.

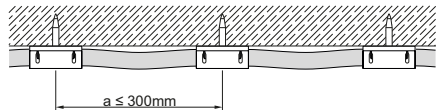

Recommended fastener spacing a:
horizontal ≤ 300 mm, vertical ≤ 400 mm

Fastener selection and system recommendation

Fastener program

Designation	Item no.	Colour	Cable diameter
X-DFC 8 MX	2143695	Red	8 mm ≤ D ≤ 8.5 mm
X-DF-W 8 MX	2143699	White	
X-DFC 9 MX	2143696	Red	8.5 mm ≤ D ≤ 9 mm
X-DFC-W 9 MX	2143730	White	

Tool selection

X-P B3 MX:	BX 3-ME	No gas can required
X-P G3 MX:	GX 3-ME	Gas can GC 40, GC 41 and GC 42

Nail recommendation

Fastening tool	Nail types	Length [mm]	Tip	Shank Ø [mm]	Material	Hardness [HRC]	Coating [µm]
BX3-ME	X-P B3 MX	17 - 20	Long-conical	3.0	Carbon steel	57.5	Zinc, 2-13
GX3-ME	X-P G3 MX					57.5	Zinc, 2-13

- For the X-DFC MX element, only 17 mm and 20 mm pin lengths are recommended in order to ensure sufficient embedment depth.
- Nails (as listed above) are recommended for wall and ceiling application (soft and some tough concrete and sandlime stone, GX/BX tools). For more details regarding nail classification and concrete types, see Concrete Fastener Selection chapter in Direct Fastening Technology Manual (DFTM).

Application requirements

Thickness of base material

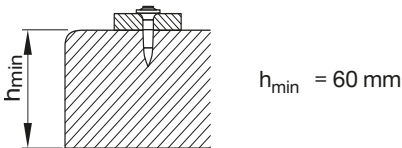

Edge distance

Min. edge distance = 70 mm

Corrosion information

Zinc-coated nails are not suitable for long-term service outdoors or in otherwise corrosive environments. For further detailed information on corrosion see relevant chapter in Direct Fastening Principles and Technique section.

Fastening quality assurance

